

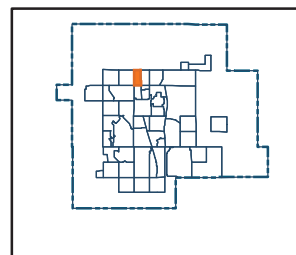

See the additional PDF pages in this document for the detailed areas.

# SILVER CREEK



- Legend**
- Registered Parcels
  - Tentative Parcels



This map is the property of the City of Airdrie and may not be reproduced, in whole or in part, in any form or by any means without the written permission of the City of Airdrie. The map is for informational purposes only and should not be relied upon. The City does not warrant that the map is correct, complete, accurate, up-to-date or otherwise reliable. Use of the map is entirely at the user's own risk. Under no circumstances shall the City be liable for any damages arising from the use of the map.

Copyright © 2019 City of Airdrie

GIS Department | Projection: 3TM WGS 1984 W114 | 18 Oct 2019

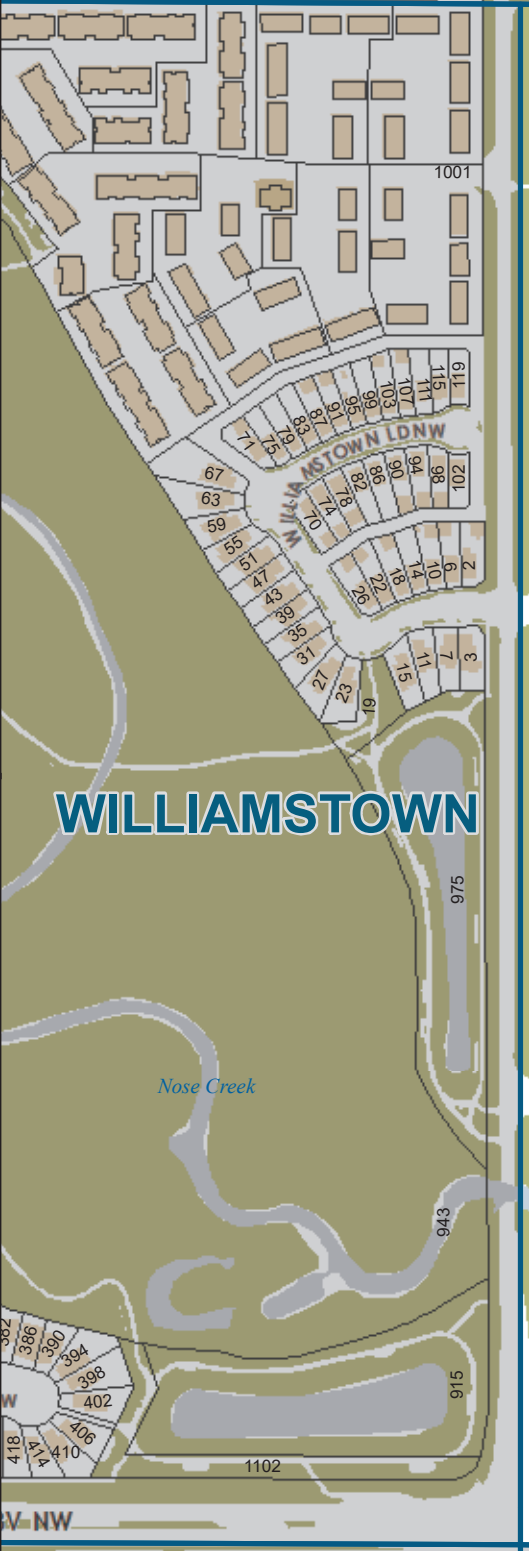
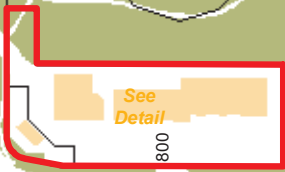
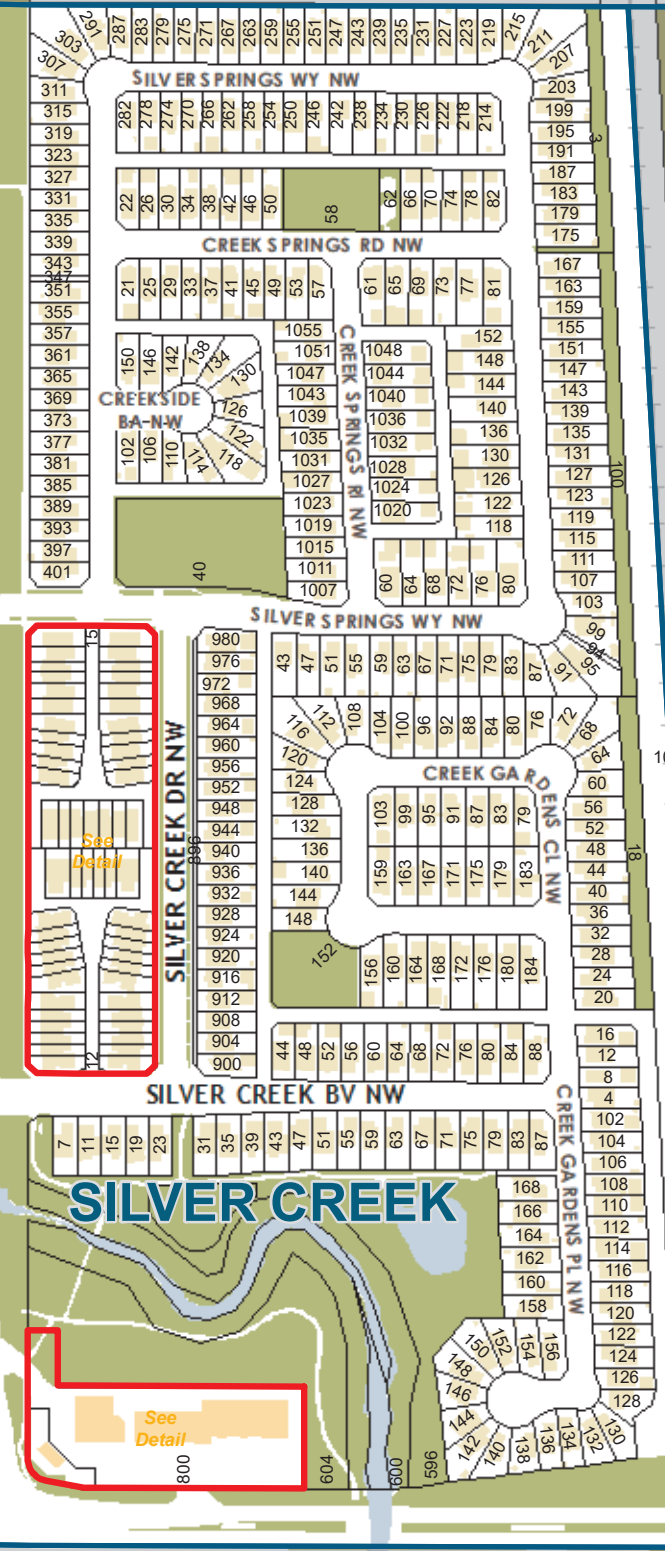
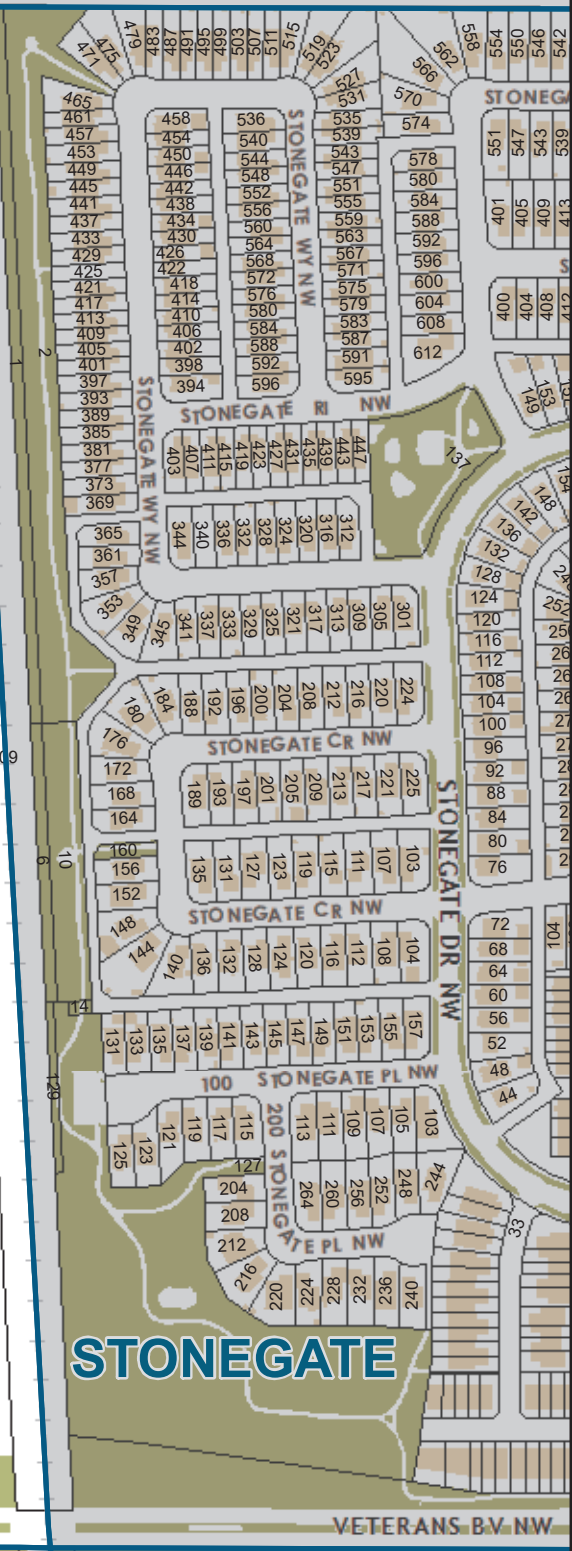

W-NW

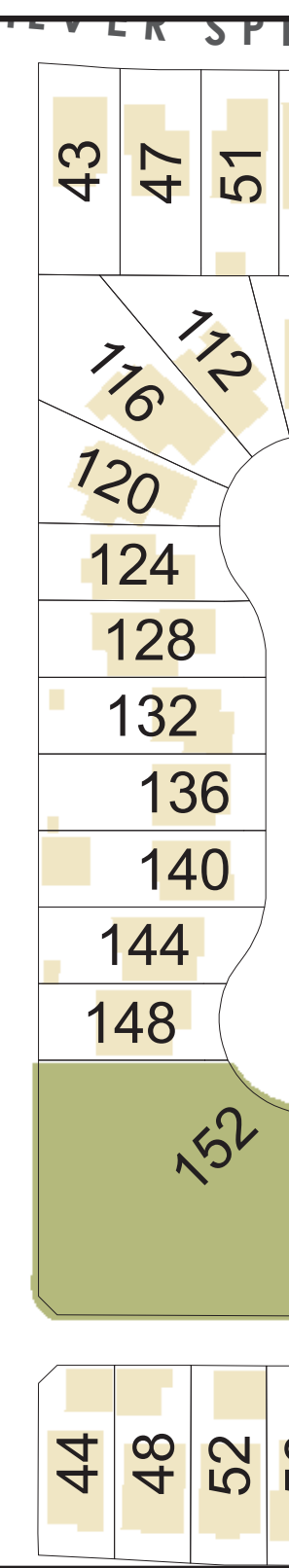
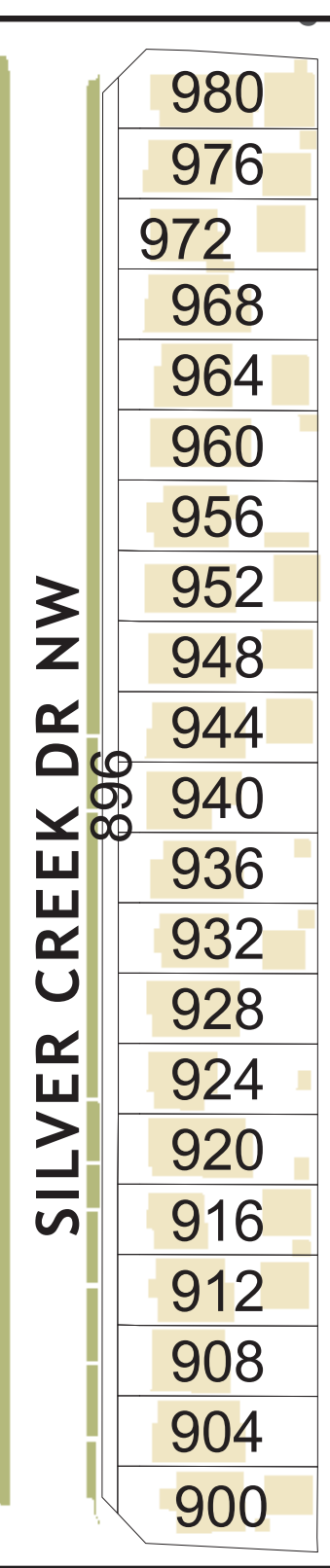
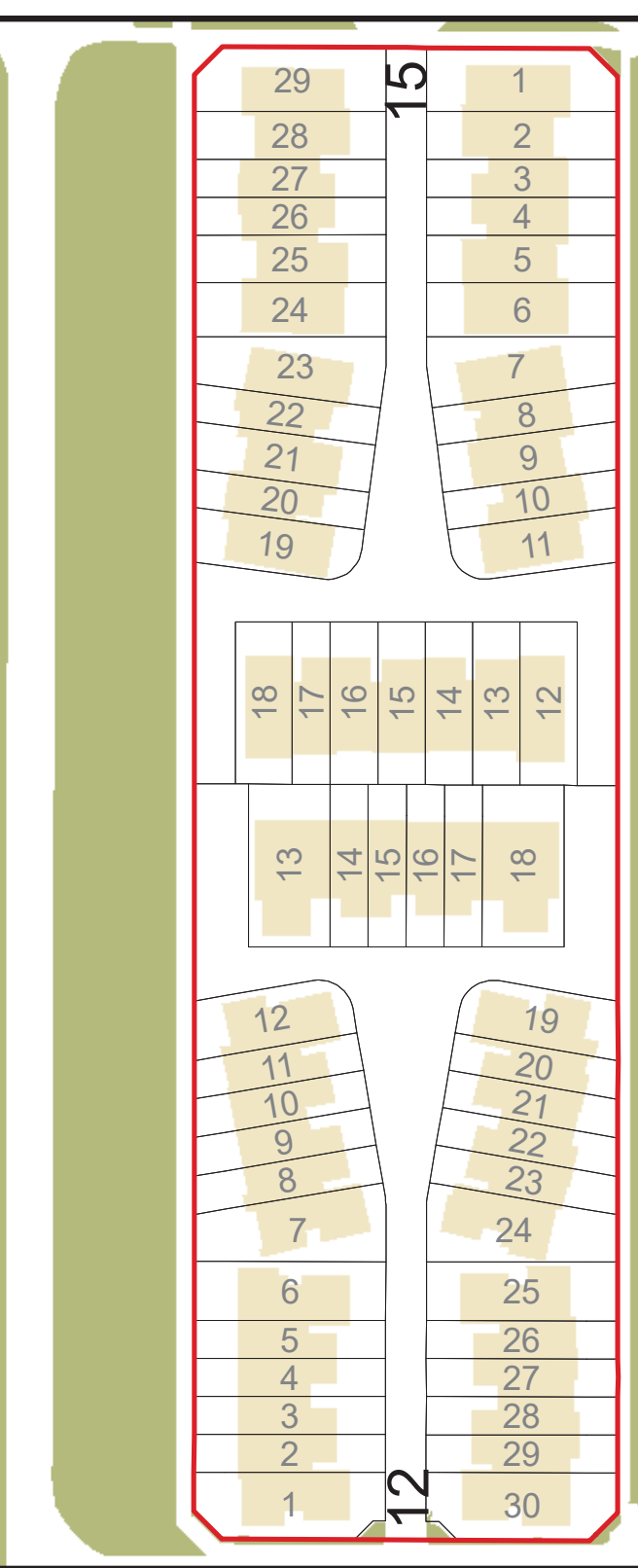
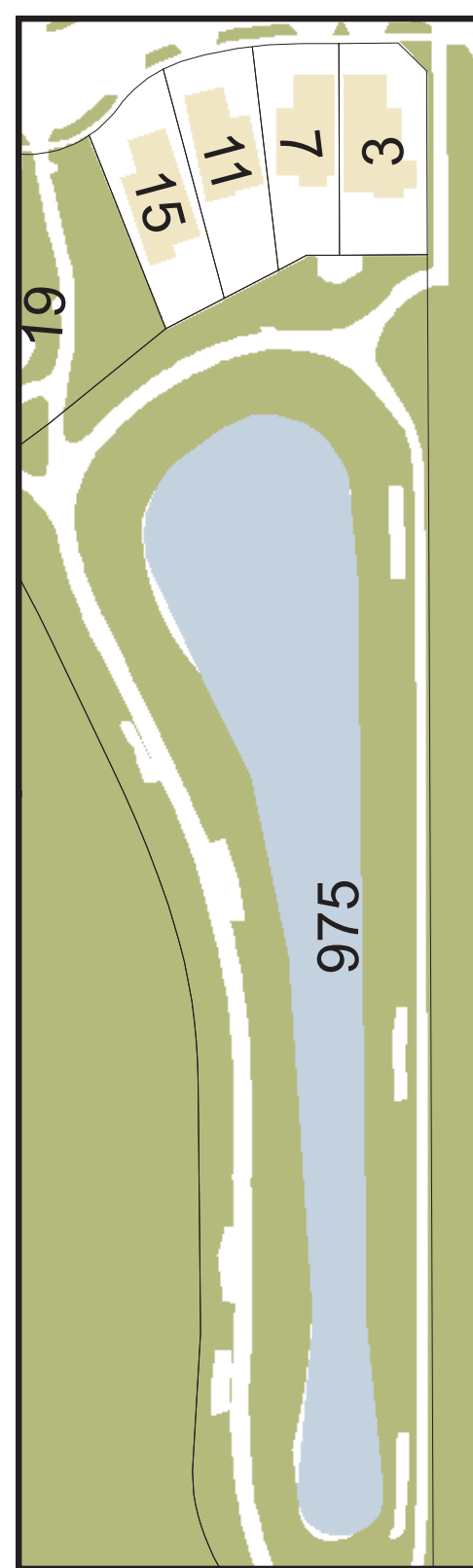

**SIL - 12 SILVER CREEK BV NW**



**Legend**  
 Registered Parcels  
 Tentative Parcels



This map is the property of the City of Airdrie and may not be reproduced, in whole or in part, in any form or by any means without the written permission of the City of Airdrie. The map is for informational purposes only and should not be relied upon. The City does not warrant that the map is correct, complete, accurate, up-to-date or otherwise reliable. Use of the map is entirely at the user's own risk. Under no circumstances shall the City be liable for any damages arising from the use of the map.  
 Copyright © 2019 City of Airdrie  
 GIS Department | Projection: 3TM WGS 1984 W114 | 18 Oct 2019



# SIL - 800 VETERANS BY NW



### Legend

- Registered Parcels
- Tentative Parcels



This map is the property of the City of Airdrie and may not be reproduced, in whole or in part, in any form or by any means without the written permission of the City of Airdrie. The map is for informational purposes only and should not be relied upon. The City does not warrant that the map is correct, complete, accurate, up-to-date or otherwise reliable. Use of the map is entirely at the user's own risk. Under no circumstances shall the City be liable for any damages arising from the use of the map.